



PERMATA HIJAU  
SUITES

L i v i n g   i n   P e r f e c t   H a r m o n y



**PERMATA HIJAU**  
**SUITES**

L i v i n g   i n   P e r f e c t   H a r m o n y



# THE ART OF LIVING

LIFE IS SO PRECIOUS AND THE WAY WE APPRECIATE LIFE IS AN ART, THAT'S WHY PERMATA HIJAU SUITES OFFER ONE SALIENT WAY TO APPRECIATE LIFE.

PERMATA HIJAU SUITES IS BUILT WITH THE SOUL OF HARMONY BY ORCHESTRATING NATURES TO BE YOUR HOME YET YOU WILL ALSO INDULGE WITH MODERN LIFESTYLE. YOU WILL FEEL HARMONY INSIDE YOUR MIND, YOUR BODY AND YOUR SOUL AT ONCE.

PERMATA HIJAU SUITES' PREMIUM LIFESTYLE IS FOR PRESTIGIOUS PEOPLE LIKE YOU WHO WILL GAIN HEALTH AND PROSPERITY AS THE EFFECT OF PEACEFUL, BEAUTIFUL AND VALUABLE LIVING ENVIRONMENT.

TUNE YOUR LIFE INTO THE ART OF TRUE LIVING, YOU AND YOUR FAMILY WORTH THIS PRECIOUS HOME.

IN PERMATA HIJAU SUITES YOU WILL BE PAMPERED WITH LUXURIOUS AND BEAUTIFUL FACILITIES: THE GRAND LOBBY, CLUB LOUNGE, SPA, JACUZZI, GYM & FITNESS CENTRE, AQUA GYM, YOGA AREA, EXERCISE POOL & LEISURE POOL, BASKETBALL 3 ON 3, PRIVATE DINING HALL, LIBRARY, ALFRESCO, BBQ AREA AND MANY MORE.

WHEN YOU LOVE NATURE, YOU WILL FALLING IN LOVE WITH PERMATA HIJAU SUITES EVERYDAY.



# SPLENDID TWIST AT SOUTH JAKARTA

PERMATA HIJAU SUITES IS LOCATED IN THE HEART OF JAKARTA. WE CHOOSE THE LOCATION BECAUSE WE UNDERSTAND THAT EXTRAORDINARY PEOPLE LIKE YOU ARE SO BUSY AND NEED GOOD ACCESS FROM YOUR LIVING PLACE. LIVING IN THE PERMATA HIJAU SUITES IS HAVING A NATURAL LIVING ATMOSPHERE BUT STILL YOU HAVE ACCESS TO MODERN LIFESTYLE PLACES SUCH AS SCHOOLS AND SHOPPING MALLS.

YOU WILL LIVE IN SOUTH JAKARTA THAT KNOWN AS THE MOST PRESTIGIOUS AREA AND THE LOCATION WILL GRANT YOU SMOOTH ACCESS TO THE MOST INTERESTING SPOTS AROUND THE CITY.

ALL THOSE THINGS ARE AVAILABLE INSIDE PERMATA HIJAU SUITES, THE FACILITIES INTEGRATED WITH LANDSCAPES WERE DESIGNED EXCLUSIVELY FOR YOU AND FAMILY.

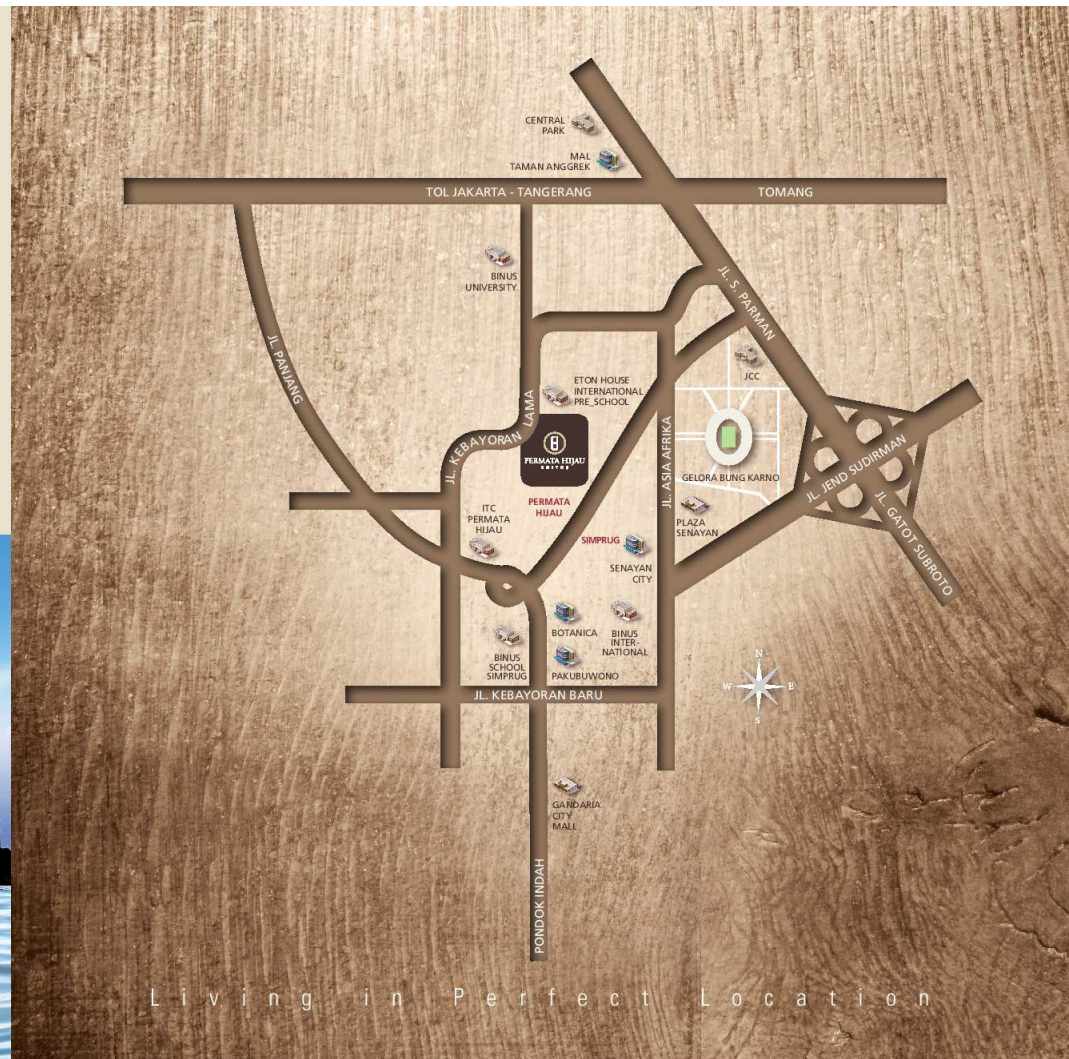

Prestigious Atmosphere



## EXTREMELY NATURAL

IT'S ONLY HALF RIGHT WHEN YOU THINK PERMATA HIJAU SUITES OFFER YOU PREMIUM LIFESTYLE. INDEED THIS MASTERPIECE WAS SCULPTURED BY LEARNING HUMAN AND NATURES; THE DESIGNERS PURSUE PERFECTION AND DEDICATE EVERY DETAIL ON THE HARMONY OF LIFE.

THE TWO TOWERS, EBONY & IVORY EXPRESS THE PHILOSOPHY OF HARMONY. THE EBONY IVORY TOWER EXPRESSING THE POSITIVE POWER OF CALMNESS, HAPPINESS, HEALTH AND PEACE, THE GLORY, PROSPERITY, ESTABLISHMENT AND HARMONY. SO YOUR LIFE WILL BE ABUNDANTLY FILLED WITH JOY AND POSITIVE SPIRITS.

PERMATA HIJAU SUITES IS AN ELEGANT PLACE TO LIVE, AND TO BE OWNED BY THE PEOPLE WHO VALUE CLEAN, HEALTHY AND NATURAL LIVING CONCEPT. YOU WILL FEEL LIKE LIVING ON MOUNTAINS AND NEAR TO THE SEA AS YOUR DAILY EXPERIENCE WHILE YOU ARE STILL DOING YOUR ACTIVITIES IN MODERN LIFESTYLE.



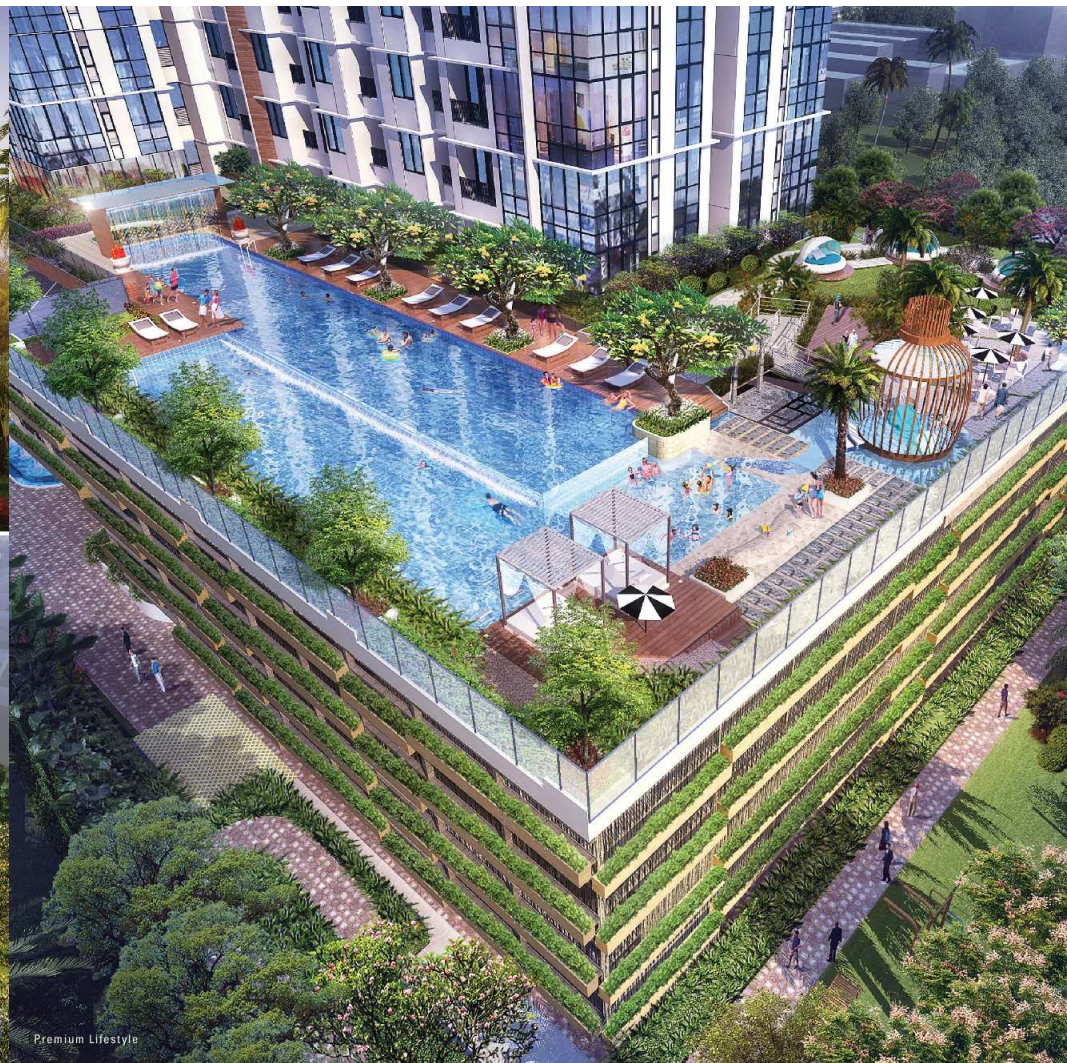

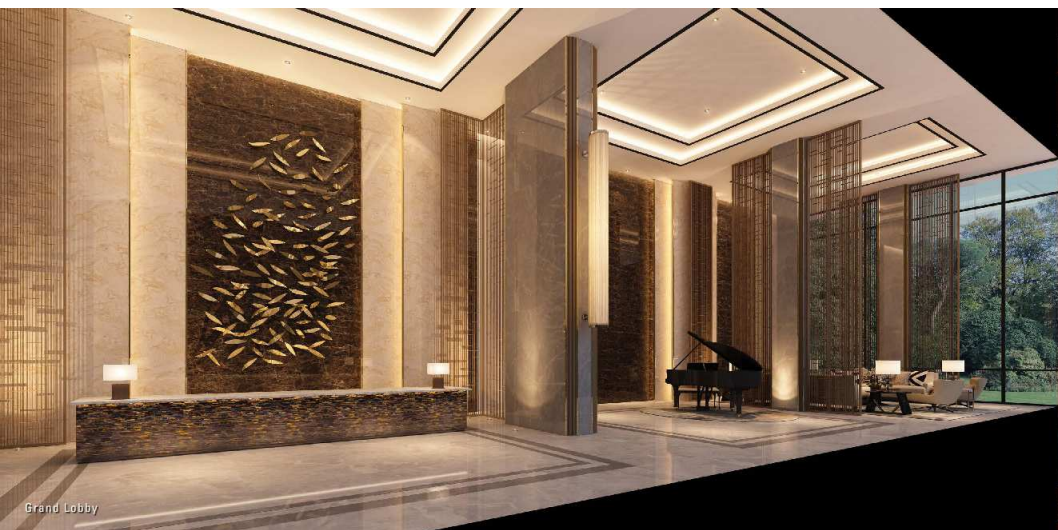



Three on Three Basketball



Children Daycare



Children Playground



Alfresco



Jacuzzi



Spa



Double Best Views

36 FLOORS · ±9000 M2 AREA · 2 TOWERS · 649 UNITS APARTMENT · 3 FLOOR BASEMENT PARKING (360 CARS)





# 01 BEDROOM



## 1BR-A

Nett area: 35,01 m<sup>2</sup>  
Semigross: 40,86 m<sup>2</sup>



## 1BR-B

Nett area: 35,01 m<sup>2</sup>  
Semigross: 40,86 m<sup>2</sup>



# 02 BEDROOM



## 2BR-A

Nett area: 51.66 m<sup>2</sup>  
Semigross: 60.29 m<sup>2</sup>



## 2BR-B

Nett area: 51.66 m<sup>2</sup>  
Semigross: 60.29 m<sup>2</sup>



## 2BR-C

Nett area: 59.46 m<sup>2</sup>  
Semigross: 69.39 m<sup>2</sup>



# 03 BEDROOM



## 3BR-A

Nett area (w/balcony) : 78.56 m<sup>2</sup>  
Semigross : 91.69 m<sup>2</sup>



## 3BR-B

Nett area (w/balcony) : 78.32 m<sup>2</sup>  
Semigross : 91.40 m<sup>2</sup>



## 3BR-C

Nett area: 78.32 m<sup>2</sup>  
Semigross: 91.40 m<sup>2</sup>



# TECHNICAL SPECIFICATION

MAIN DOOR	: Solid Engineering Door
WINDOWS	: Powder Coating Aluminum Frame with Glass
CEILING	: Gypsum Board
FLOOR UNIT	
Master Bedroom	: Marble
Bedroom	: Marble
Living Room	: Marble
Dining Room	: Marble
Bathroom	: Homogeneous Tile
Service Area	: Ceramic
Balcony	: Ceramic
KITCHEN	: Kitchen Table with Single Bowl Mixing Valve
BATHROOM	
Water Heater	: 1 Outlet Installation
Sanitary	: TOTO
PHONE	: 1 Outlet Installation
TV	: 1 Outlet Installation
AIR CONDITION	: 1 BR = 2 Units 2 BR = 3 Units 3 BR = 4 Units
ELECTRICITY	: 1 BR = 3.500 VA 2 BR = 4.400 VA 3 BR = 6.600 VA

L i v i n g   i n   P e r f e c t   H a r m o n y

While every reasonable care has been taken during preparation of this brochure, the developer and its agents cannot be held responsible for any inaccuracies. The reader will release any liabilities on the developer, agents, and all other third parties. All statements are believed to be correct but are not to be regarded as statements of fact. All information and specifications are current at the time of print and are subject to change without prior notice as they are required and cannot be taken out of their original context. All items are subject to any government approvals or other relevant parties. Requirements and specifications are strictly prescriptive only and cannot be regarded as representative of fact. All figures are not to scale, approximate, and subject to other conditions. Size and dimension are approximate measurements using equipment, criteria and method determined by the developer. The developer has the right to determine the schedule, plan, and design of the project among other things with prior notice. The suggested recommendation of any subject by the developer, its agents and third parties may be incorrect and inaccurate and it is only a reference that is subject to further research by the reader.

021 5366 9600

PT. PALMERINDO PROPERTI • Jl. Raya Kebayoran Lama No. 55, Kebayoran Lama, Jakarta 12210

[www.permatahijausuites.com](http://www.permatahijausuites.com)

Developed by:

**PULAUINTAN**  
DEVELOPMENT

TERRY PALMER  
group

**ATEJA** GROUP

Property Management:

 JONES LANG  
LASALLE